

Flatback Style
(- 2) Series



Dish Style
(- 0) Series

How to use the selector chart

The first three digits refer to the outside diameter in millimeters, the remaining digits refer to the hub series.

For the hub, the digits before the dash represent the hub series and the digits after represent the bore size.

Example:

Fan Part No. 21633 is a fan with an outside diameter of 216mm which uses a 33 hub series.

Hub Part No. 33-1125 represents a 33 series hub with a 1-1/8" bore.

EZE-Fans® & EZE-Fans® Plastic Replacement Fans & Hubs

Part No.	Diameter	Min. Dia.	Height	Part No. / Bore Size										Maximum Bore
				11-5000	11-6250	11-14	11-15	11-16	11-18	11-19	11-20	11-22	11-00	
12411-0	124mm	102mm 4"	1"	1/2"	5/8"	14mm	15mm	16mm	18mm	19mm	20mm	22mm	Un-bored	1" 25mm
12411-2	4-7/8"		7/8"											
13211-0	132mm		1"											
13211-2	5-3/16"		7/8"											
14911-0	149mm		1-1/8"											
14911-2	5-7/8"		7/8"											
				22-5000	22-6250	22-7500	22-8750	22-24	22-25	22-30			22-00	
16622-0	166mm	140mm	1-1/4"	1/2"	5/8"	3/4" 19mm	7/8"	24mm	25mm	30mm			Un-bored	1-1/2" 38mm
16622-2	6-9/16"	5-1/2"	1-7/16"											
17022-0	170mm	146mm	2-3/16"											
17022-2	6-3/4"	5-3/4"	1-7/16"											
				33-8750	33-1125	33-1375	33-1500	33-28	33-30	33-32	33-40	33-45	33-00	
21633-0	216mm	175mm	1-3/4"	7/8"	1-1/8"	1-3/8"	1-1/2"	28mm	30mm	32mm	40mm	45mm	Un-bored	2-3/8" 60mm
21633-2	8-1/2"	6-7/8"	1-7/16"											
24633-0	246mm	202mm	2-3/16"											
24633-2	9-3/4"	7-15/16"	1-7/16"											



Flatback Style
(- 2) Series

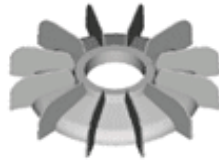

Dish Style
(- 0) Series

How to use the selector chart

The first three digits refer to the outside diameter in millimeters, the remaining digits refer to the hub series.

For the hub, the digits before the dash represent the hub series and the digits after represent the bore size.

Example:

Fan Part No. 21633 is a fan with an outside diameter of 216mm which uses a 33 hub series.

Hub Part No. 33-1125 represents a 33 series hub with a 1-1/8" bore.

EZE-Fans® & EZE-Fans® Plastic Replacement Fans & Hubs

Part No.	Diameter	Min. Dia.	Height	Part No. / Bore Size								Maximum Bore		
				44-1375	44-1625	44-1875	44-42	44-45	44-50					44-00
29844-0	298mm	242mm	2-3/16"	1-3/8"	1-5/8"	1-7/8"	42mm	45mm	50mm				Un-bored	2-1/2" 65mm
29844-2	11-3/4"	9-9/16"	1-3/4"											
33344-0	333mm	270mm	2-3/16"											
33344-2	13-1/8"	10-5/8"	1-3/4"											
				55-2000	55-2125	55-2250	55-2375	55-2500	55-2875	55-3375			55-00	
35555-0	355mm	290mm	2-3/8"	2"	2-1/8"	2-1/4"	2-3/8"	2-1/2"	2-7/8"	3-3/8"			Un-bored	3-3/4" 95mm
35555-2	14"	11-1/2"	1-15/16"											
38155-0	381mm	315mm	2-3/8"											
38155-2	15"	12-1/2"	1-15/16"											
40655-0	406mm	340mm	2-3/8"											
40655-2	16"	13-3/8"	1-15/16"											
43155-0	431mm	355mm	2-3/8"											
43155-2	17"	14"	1-15/16"											